

Bronze Bus Support Clamps

Type BSR

For copper tube or cable to bolt circle

- Manufactured from high strength cast copper alloy
- Designed for mounting a wide range of cable or tube on post or pedestal type insulator
- Furnished with silicon bronze clamping hardware for corrosion resistance
- Stainless steel bolts and lockwashers furnished for cap mounting (standard)
- Oval slots in base permit easy alignment
- For stainless steel base mounting hardware consisting of bolts, nuts, and lockwashers, suffix catalog number with “-BM”
- For tin plating, suffix catalog number with “-TN”

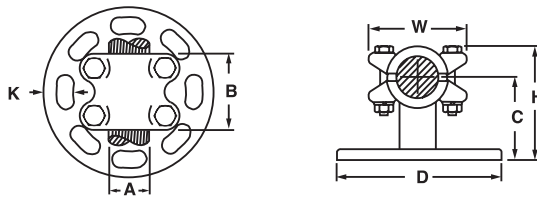

CATALOG NUMBER	IPS RANGE	COPPER CONDUCTOR RANGE	BOLT CIRCLE DIA.	APPROXIMATE DIMENSIONS (IN.)						BOLT SIZE
				B	C	D	H	W	K (SLOT WIDTH)	
BSR-1	1/8 - 1/2	6 Str. - 500 kcmil	3.00	2.75	2.00	4.25	3.19	2.19	.56	3/8
BSR-2			5.00	2.75	2.06	6.38	3.25	2.19	.69	
BSR-5	1/4 - 1	4/0 Str. - 1250 kcmil	3.00	3.00	2.13	4.25	3.63	2.69	.56	
BSR-6			5.00	3.00	2.19	6.38	3.69	2.69	.69	
BSR-9	3/4 - 1 1/2	850 - 2500 kcmil	3.00	3.88	2.44	4.25	4.19	3.69	.56	1/2
BSR-10			5.00	3.88	2.50	6.38	4.25	3.69	.69	
BSR-11	1 1/4 - 2	-	3.00	2.88	2.56	4.25	4.31	4.19	.56	
BSR-12			5.00	2.88	2.63	6.38	4.38	4.19	.69	